

MANUAL

AL 17-20

1. Use

1.1 Life of valve can be maximized if the valve is used within the rated range, in accordance with pressure, temperature, and corrosion data.

2. Manual operation

2.1 To open or close the valve, turn the handle $\frac{1}{4}$ turn (90 degrees).

A. Valve in Open Position - the handle is in parallel (in-line) with the valve or pipeline.

B. Valve in Closed Position - the handle is perpendicular (crossed) with the valve or pipeline.



3. Disassembling & cleaning

3.1 Ball valves can trap fluids in ball cavity when it is in closed position.

3.2 If the valve has been used in hazardous media, it must be decontaminated before disassembly.

A. Relieve the line pressure.

B. Place valve in half-open position and flush the line to remove any hazardous material from valve.

C. All persons involved in the removal and disassembly of the valve should wear the proper protective clothing, such as face shield, glove, apron, etc.

4. Replacing the thrustwasher, packing, and seats

4.1 Before replacing the thrust washer and the packing, the pipeline must be de-pressurized.

4.2 Take-off the valve from the pipeline.

4.3 Place valve in its' fully open position.

4.4 Take-off end cap with proper equipment (machine).

4.5 Close the valve and remove the seat, body seals and ball.

4.6 Remove the valve stem nut, handle, gland nut and remove the valve stem through the body cavity.

4.7 Remove the stem thrust washer from the stem cavity.

4.8 Examine all metallic sealing surfaces such as ball, stem and end cap for damage, if the ball or stem is excessively damaged, ball and stem need to be replaced.

5. Re-assembling

Having assured that all critical surfaces and components have been inspected, cleaned and or replaced, reassemble can be begun.

5.1 Place new thrust washer on stem and install the stem.

5.2 Re-install gland nut and tighten to the torques listed on table.

5.3 Lightly lubricate seats and body seals using a lubricant.

5.4 Re-install end cap.

5.5 Re-install handle and secure with stem nut.

MANUAL

AL 17-20

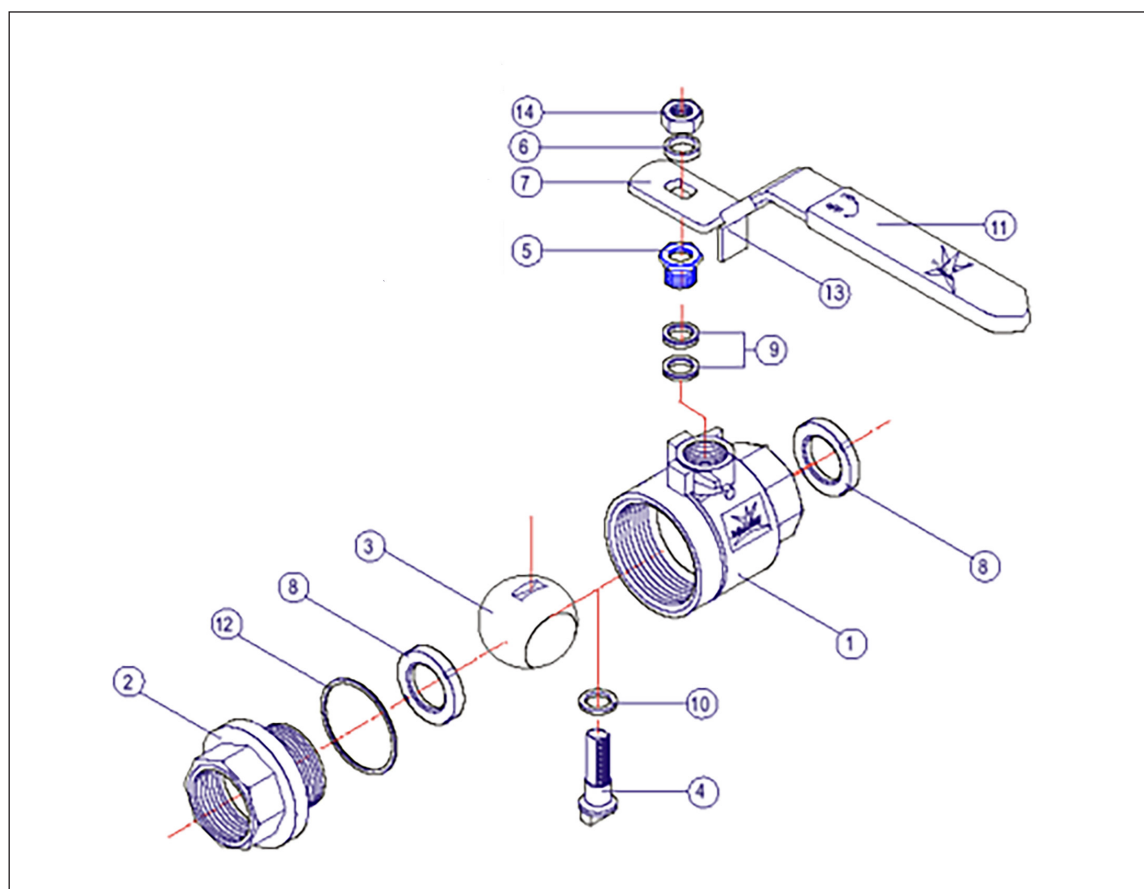

Material specification

No	Qty	Part	Material
1	1	Body	Stainless steel CF8M / WCB
2	1	End cap	Stainless steel CF8M / WCB
3	1	Ball	Stainless steel SS 316
4	1	Stem	Stainless steel SS 316
5	1	Gland nut	Stainless steel SS 304
6	1	Stem washer	Stainless steel SS 301
7	1	Handle	Stainless steel SS 304
8	2	Seat	PTFE
9	1 set	V-ring packing	PTFE
10	1	Stem seal	RTFE
11	1	Handle sleeve	Vinyl
12	1	Joing gasket	PTFE
13	1	Locking device	Stainless steel SS 304
14	1	Handle nut	Stainless steel SS 304

Pressure / Temperature

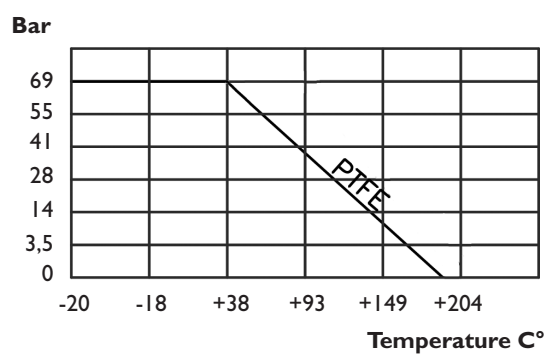
AXEL LARSSON

Telephone +46 10 455 97 00 • sales@axel-larsson.se • www.axel-larsson.se

STOCKHOLM | GÖTEBORG | MOTALA | FALUN | UMEÅ

Head Office: Truckvägen 12, P.O. Box 805, SE-194 28 Upplands Väsby (Stockholm), Sweden.