

# BALL VALVE

## AL 39-PZ

### Description

AL 39-PZ is a flanged 3-way valve with full bore and mounting plate according to ISO 5211. The valve has a blow-out proof antistatic stem, free floating ball and self-adjusting stem packing. Manual operation with lockable lever, gear box or actuator.

**Applications:** Shut-off valve for demanding applications, with neutral to aggressive liquids and gases

**Types:** AL 39-PZ-84-TTT - Carbon steel  
AL 39-PZ-86-TTT - Stainless steel

As standard with seat, stem sealing and primary body seal in PTFE.

**Type marking:** The valve is marked PZ.

**Connection:** Flange

**Pressure class:** PN 16 DN 25-200  
PN 40 DN 25-100

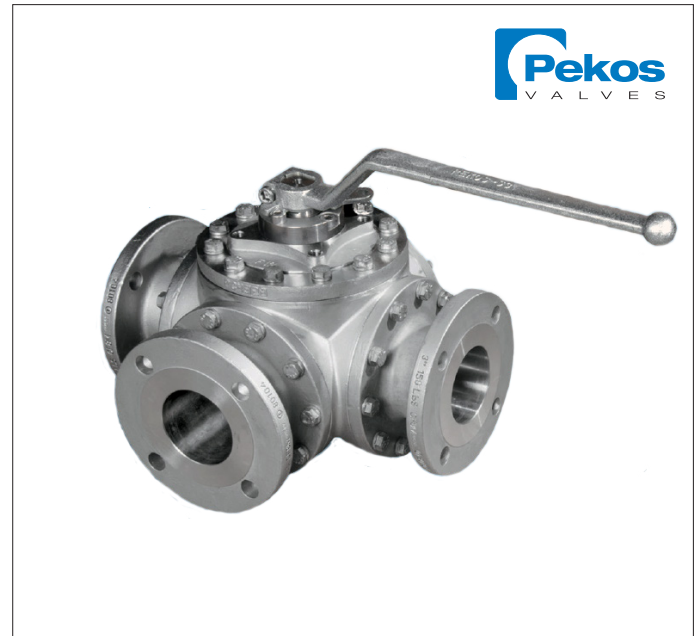

### Approvals

- CE/PED 2014/68/EU
- ATEX 2014/34/EU
- TÜV.AD-MERKBLATT WO
- TA-Luft
- FireSafe certificate
- EN161/EN23553-1
- SIL3

### Optional

- ANSI
- Stem extension
- 4-way valve
- Dimensions DN 250-500
- Pressure class PN 100
- Gearbox
- Pneumatic or electric actuator

### Installation

The valve can be installed in horizontal and vertical lines. The valve is maintenance free but should be operated at regular intervals depending on the installation. See also separate manual.

### Configurations

Standard = L1 och T1, other configurations on request.

#### 3-way

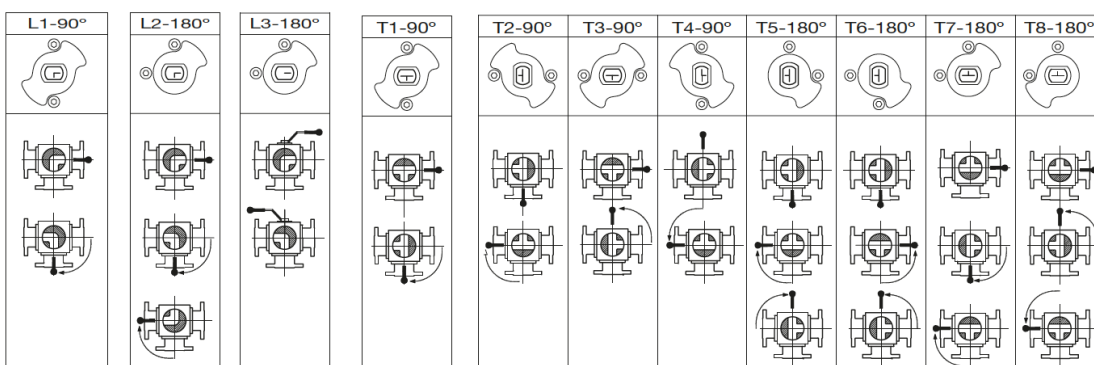

#### 4-way

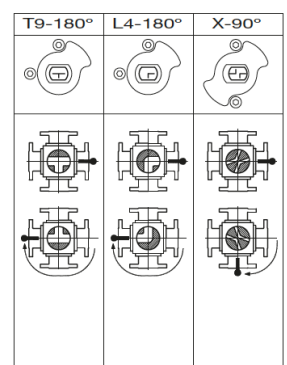

# BALL VALVE

## AL 39-PZ

### Material specification

No	Part	Carbon steel	Stainless steel
1	Body 1	Carbon steel I.0619	Stainless steel I.4408
2	Body 2	Carbon steel I.0619	Stainless steel I.4408
3	Ball	Stainless steel I.4408	
4	Seat	PTFE (modified)	
5	Stem	Stainless steel I.4401	
6	Stem seal	PTFE (modified) + FG	
7	Stem packing 1	PTFE (modified)	
7a	Stem packing 2	Graphite	
8	Gland packing	Stainless steel I.4401	
8a	Gland packing I	Stainless steel I.4401	
9	Spring washer	Stainless steel I.4310	
11	Cover	Stainless steel I.4408	
13	Cover bolt	A4-70	
14	Body seal I	PN 16: Graphite / PN 40: PTFE (modified)	
15	Body bolt	A2-70	A4-70
16	Handle	WCB	
17	Handel bolt	I.045 (8.8)	
19	Spring	Stainless steel I.4401	
20	Antistatic ball	Stainless steel I.4401	
50	Subjection ring	Stainless steel I.4021 (SS body PN 40 I.4301)	
64	Body cover	CS I.0619	SS I.4408
65	Body blind	CS I.0619	SS I.4408
66	Body cover seal	PN 16: Graphite / PN 40: PTFE (modified)	
110	Subjection ring seal	Stainless steel I.4401, nitrided	
165	Stem bearing	PTFE (modified) + Glass fiber	

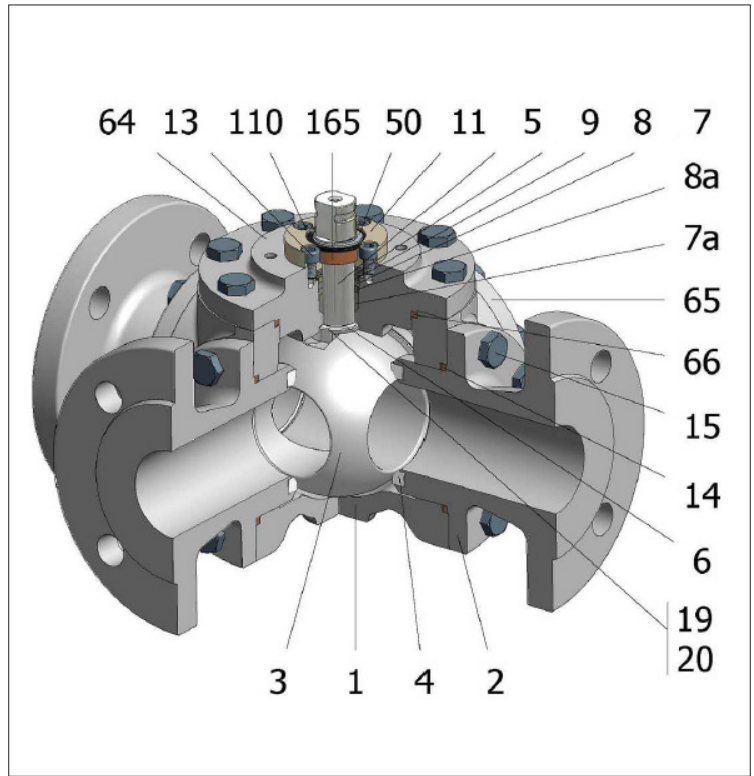

### Pressure / Temperature

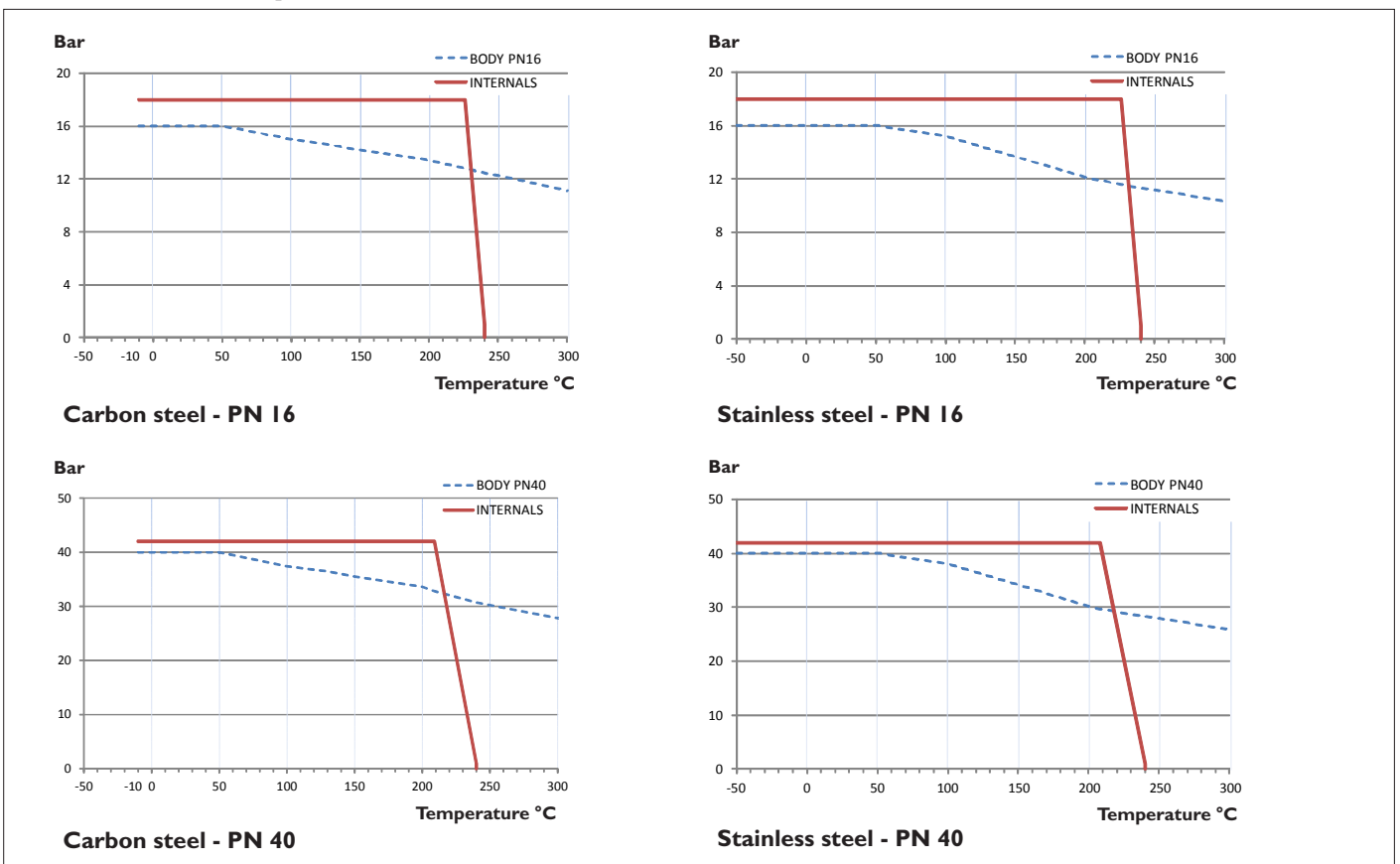

# BALL VALVE

## AL 39-PZ

### Dimensions

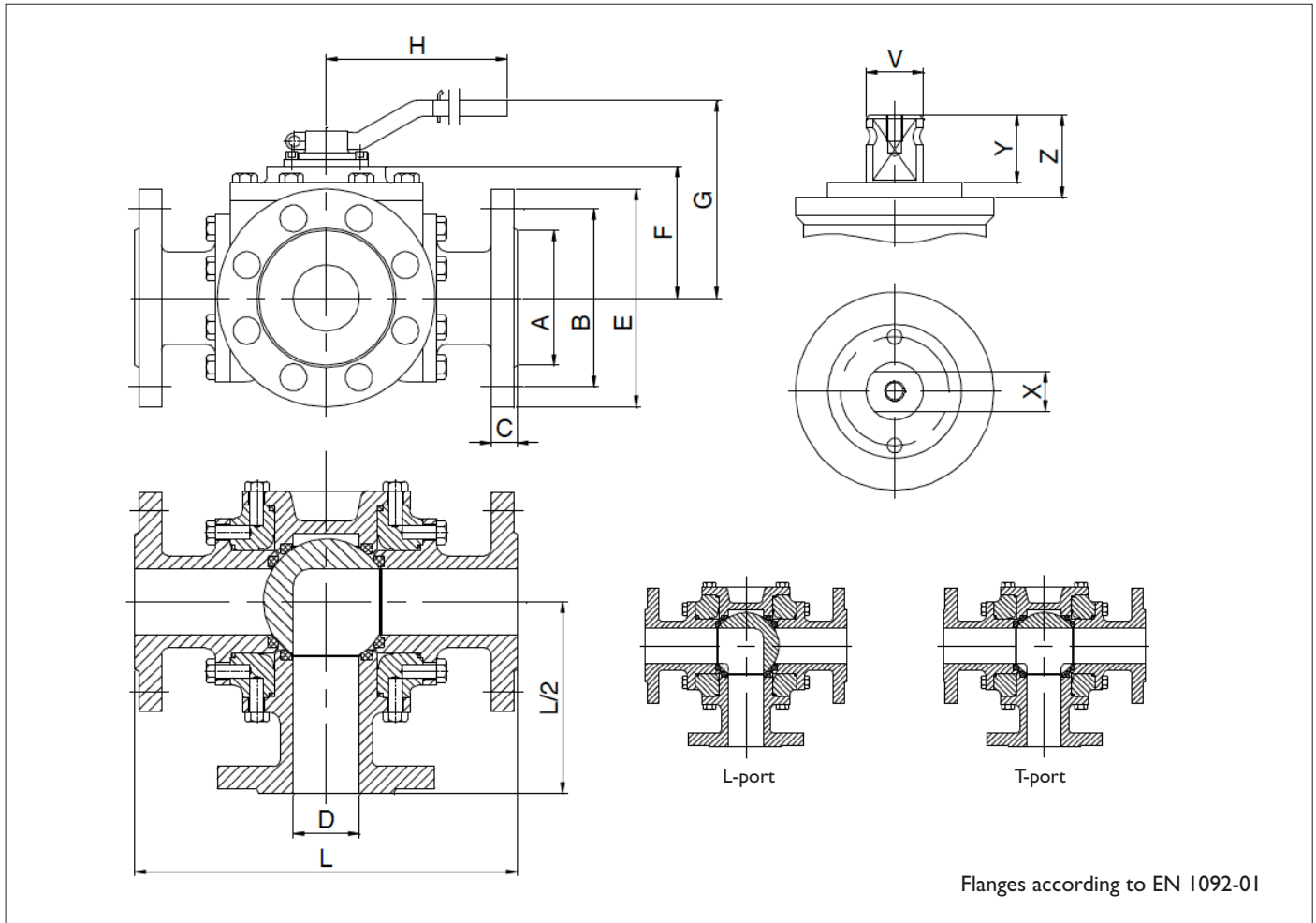

#### PN 16

DN	D	L	E	A	B	C	F	H	G	V	X	Y	Z	n x d	ISO 5211	Nm*	Weight
25	25	230	115	68	85	18	67	185	117	18	14	17	20	4 x 14	F05	21	14
40	40	260	150	88	110	18	82	293	136	22	17	20	30	4 x 18	F07	47	22
50	50	290	165	102	125	20	90	293	144	22	17	20	30	4 x 18	F07	69	30
65	65	340	185	122	145	18	109	450	182	28	22	22	40	4 x 18	F10	83	47
80	80	380	200	138	160	20	132	740	205	36	27	35	50	4 x 18	F12	128	65
100	100	430	220	158	180	20	147	740	220	36	27	35	50	4 x 18	F12	165	95
150	150	480	285	212	240	22	216	-	-	48	36	40	63	8 x 22	F14	570	180
200	201	600	340	268	295	24	258	-	-	48	36	40	63	12 x 22	F14	810	300

#### PN 40

DN	D	L	E	A	B	C	F	H	G	V	X	Y	Z	n x d	ISO 5211	Nm*	Weight
25	25	230	115	68	85	18	67	185	117	18	14	17	19,5	4 x 14	F05	27	14
40	40	260	150	88	110	18	82	293	136	22	17	20	30	4 x 18	F07	60	22
50	50	290	165	102	125	20	90	293	144	22	17	20	30	4 x 18	F07	97	30
65	65	340	185	122	145	22	109	450	182	28	22	22	40	8 x 18	F10	127	47
80	80	380	200	138	160	24	132	740	205	36	27	35	50	8 x 18	F12	195	65
100	100	430	235	162	190	24	147	740	220	36	27	35	50	8 x 22	F12	285	95

\*Torque (Nm) at room temperature and maximum pressure for the respective pressure class (without any safety factor)

# BALL VALVE

## AL 39-PZ

### Kv-value

#### L-port

DN	25	40	50	65	80	100	150	200
Kv	25	60	85	148	295	380	750	1300

#### T-port / X-port

DN		25	40	50	65	80	100	150	200
A	Port 2	20	51	75	136	215	340	705	905
B	Port 1	23	60	190	141	338	380	815	995
	Port 2	58	160	270	510	812	1380	2650	4603
C	Port 2/3	24	58	85	144	218	340	767	1150
D	Port 2	60	170	292	532	858	1425	2800	4820
E	Port 2/4	16	39	60	101	154	242	542	867

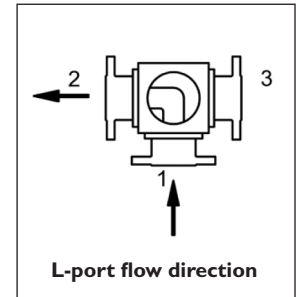

#### T/X-port flow direction

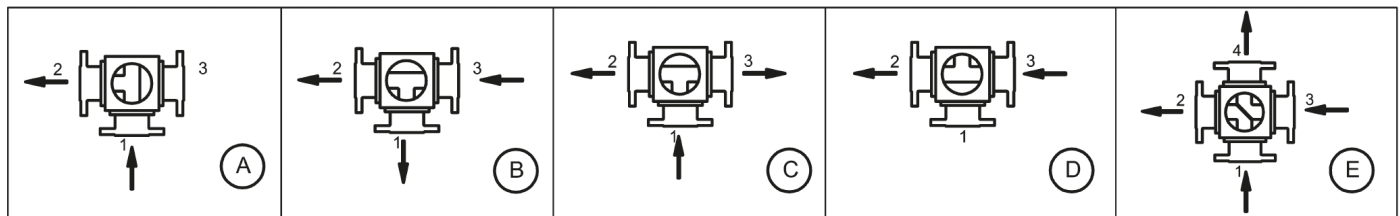

### Ordering information

Type	Design 3-way is standard	Body / Ball 4 and 6 is standard	Seat T is standard	Stem packing T is standard	Primary body seal T is standard
AL 39-PZ	3 = 3-way 4 = 4-way	4 = Carbon steel I.0619 / Stainless steel I.4408 6 = Carbon steel I.4408 / Stainless steel I.4408	T = PTFE S = PTFE + 25 % CG	T = PTFE G = Graphite S = PTFE + 25 % CG R = PTFE + 25 % VG	T = PTFE G = Graphite S = PTFE + 25 % CG R = PTFE + 25 % VG

### Ordering example

Example: AL 39-PZ - 8 - I - TTT - DN 50 - T1 - PN 40

