

MANUAL

Lucifer type 341/541 N01 • 341/342/347441 N11 • 341 N21 • 341/345/347 N31 • 341/342/347/441/541 P01 • 341/345/347 P21

Repair kit

Article number: 9804972.

Contents:

- 6 spool-seats 493081 (pre-lubricated)
- 5 cages 493083
- 1 instruction

1. Disassembly of the valve

- 1.1 Unscrew cover plate (341/345/441/541 valves)
- 1.2 Unscrew pilot (2 pilots in 342/347 valves) keeping the piston and the seals in place.
- 1.3 Pull out spool and spring (spring only in 341/345/441/541 valves)
- 1.4 Remove initial cage(s).
- 1.5 Push spool seals and cages through valve body.



2. Resassembly of the valve

- 2.1 Screw cover plate (341/345/441/541 valves)
- 2.2 Push spool seal, followed by cage into the central body hole.
- 2.3 Repeat 2.2 until 5 cages and 6 seals are placed.
- 2.4 At the end, a seal must be visible.
- 2.5 Reposition the initial cage(s)
- 2.6 Insert spool with spring (spring only in 341/345/441/541 valves)
- 2.7 Screw pilot (2 pilots in 342/347 valves) with piston and seals.

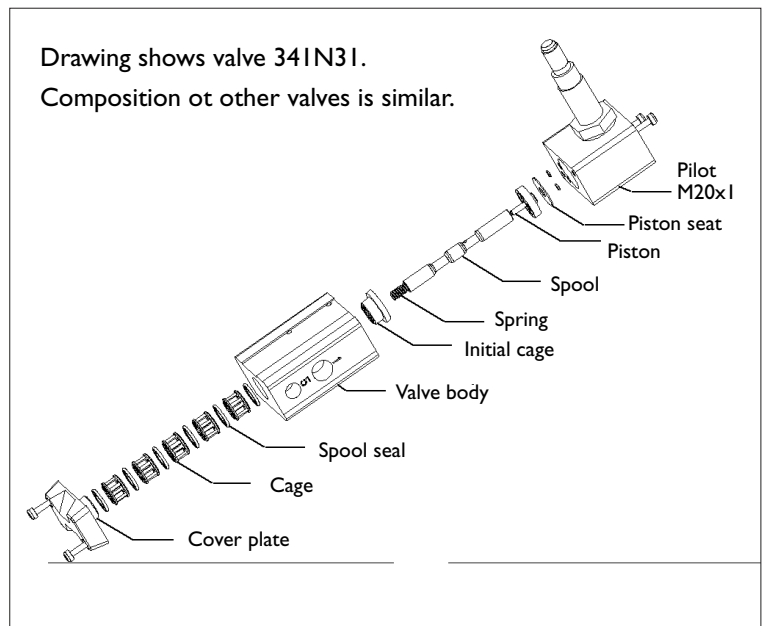

3. Starting the valve

- 3.1 Make some commutations at minimum 2 bar pressure.

AXEL LARSSON 

Telephone +46 10 455 97 00 • sales@axel-larsson.se • www.axel-larsson.se

STOCKHOLM | GÖTEBORG | MOTALA | KARLSTAD | FALUN | SKELLEFTÅ

Head Office: Truckvägen 12, P.O. Box 805, SE-194 28 Upplands Väsby (Stockholm), Sweden.